

Exploded diagram and spare parts list

For machines with - R290 refrigerant

[Click](#)

From 5076988-UK(S/N:8195988), 22343-EU onward

For machines with – R404a refrigerant

[Click](#)

Prior to 5076988-UK(S/N:8195988), 22343-EU

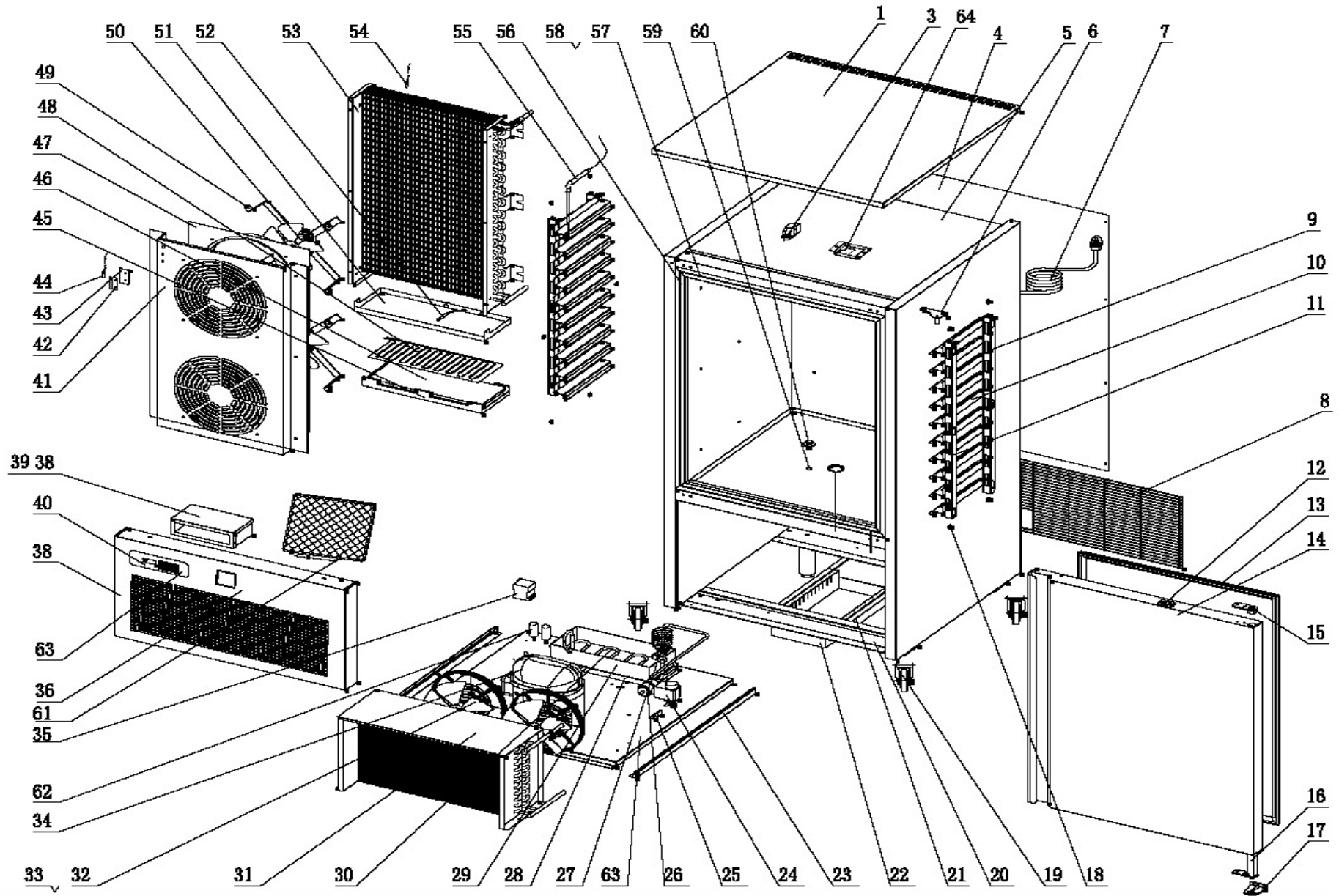



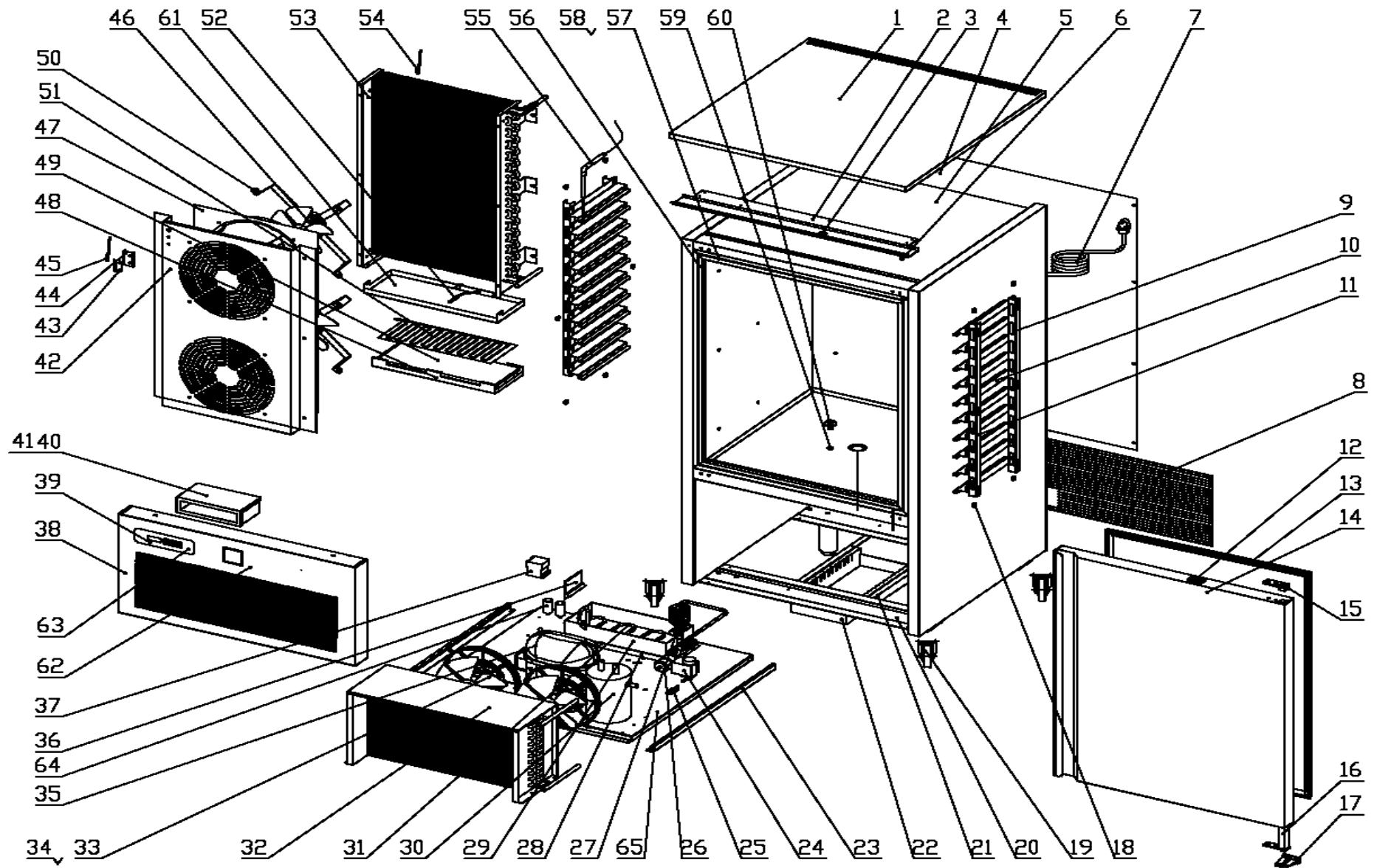

Machine	Explode	Code	Description
DN494 - Polar Blast Chiller 40/28kg	1	AM146	Top
DN494 - Polar Blast Chiller 40/28kg	3	AB888	Door Switch
DN494 - Polar Blast Chiller 40/28kg	4		Body Back Cover
DN494 - Polar Blast Chiller 40/28kg	5		Body
DN494 - Polar Blast Chiller 40/28kg	6	AK616	Upper Hinge Right
DN494 - Polar Blast Chiller 40/28kg	7	AG554	UK Plug
DN494 - Polar Blast Chiller 40/28kg	7		EU Plug
DN494 - Polar Blast Chiller 40/28kg	8		Unit Room Grill
DN494 - Polar Blast Chiller 40/28kg	9	AE238	Back Support Left & Right
DN494 - Polar Blast Chiller 40/28kg	11		Front Support Left & Right
DN494 - Polar Blast Chiller 40/28kg	10	AK185	Guide Left & Right
DN494 - Polar Blast Chiller 40/28kg	12	AK617	Door Switch Cushion
DN494 - Polar Blast Chiller 40/28kg	N/A	AM835	Screws M4X17 for Door Switch Cushion
DN494 - Polar Blast Chiller 40/28kg	13	AF649	Door Seal
DN494 - Polar Blast Chiller 40/28kg	14	AL373	Door (Door With Handle)
DN494 - Polar Blast Chiller 40/28kg	15	AB287	Down Hinge Axis Jacket
DN494 - Polar Blast Chiller 40/28kg	16	AB346	Door Spring Hinge
DN494 - Polar Blast Chiller 40/28kg	17	AE220	Door Hinge
DN494 - Polar Blast Chiller 40/28kg	18		Support Tray Nut
DN494 - Polar Blast Chiller 40/28kg	19	AE824	Standard & Braked Castors
DN494 - Polar Blast Chiller 40/28kg	20		Unit Support Board
DN494 - Polar Blast Chiller 40/28kg	21		Water Box Guide
DN494 - Polar Blast Chiller 40/28kg	22	AB982	Water Box
DN494 - Polar Blast Chiller 40/28kg	23		Guide of Unit Board Left & Right
DN494 - Polar Blast Chiller 40/28kg	24	AH325	Solenoid Valve
DN494 - Polar Blast Chiller 40/28kg	25		Solenoid Valve Fixed Clip
DN494 - Polar Blast Chiller 40/28kg	26	AE225	Filter Drier
DN494 - Polar Blast Chiller 40/28kg	27	AE239	Thermostatic Expansion Valve
DN494 - Polar Blast Chiller 40/28kg	28	AK618	Protector for Water Pan
DN494 - Polar Blast Chiller 40/28kg	29	AF875	Water Pan
DN494 - Polar Blast Chiller 40/28kg	30	AP750	Discharge Pipe (R290)
DN494 - Polar Blast Chiller 40/28kg	31		Microchannel Condenser (R290)
DN494 - Polar Blast Chiller 40/28kg	32	AE228	Condenser Fan & Blade
DN494 - Polar Blast Chiller 40/28kg	33	AA658	Basket Guard Grill
DN494 - Polar Blast Chiller 40/28kg	34	AJ141	Compressor (R290)
DN494 - Polar Blast Chiller 40/28kg	35	AF808	Ac Contactor
DN494 - Polar Blast Chiller 40/28kg	36	AG970	Front Panel (incl. facia)
DN494 - Polar Blast Chiller 40/28kg	37	AG968	Thermostat
DN494 - Polar Blast Chiller 40/28kg	38	AP235	Thermostat Protector
DN494 - Polar Blast Chiller 40/28kg	39	AP236	Thermostat Cover
DN494 - Polar Blast Chiller 40/28kg	40	AG970	Thermostat Sticker
DN494 - Polar Blast Chiller 40/28kg	41		Condenser Fan Support
DN494 - Polar Blast Chiller 40/28kg	42	AA639	Sensor Fixed Clip

DN494 - Polar Blast Chiller 40/28kg	43	AB953	Probe Padding
DN494 - Polar Blast Chiller 40/28kg	44	AJ547	Room Temperature Sensor
DN494 - Polar Blast Chiller 40/28kg	45	AK625	Inside Bottom Pan
DN494 - Polar Blast Chiller 40/28kg	46		Heat Preservation Foam
DN494 - Polar Blast Chiller 40/28kg	47		Airflow Conduct Board
DN494 - Polar Blast Chiller 40/28kg	48	AK631	Heater
DN494 - Polar Blast Chiller 40/28kg	49		Circuit Fan Support
DN494 - Polar Blast Chiller 40/28kg	50	AE236	Circuit Fan
DN494 - Polar Blast Chiller 40/28kg	51	AK186	Evaporator Water Pan
DN494 - Polar Blast Chiller 40/28kg	52	AK632	Drain Heater
DN494 - Polar Blast Chiller 40/28kg	53	AG965	Evaporator
DN494 - Polar Blast Chiller 40/28kg	54	AK135	Defrosting Sensor
DN494 - Polar Blast Chiller 40/28kg	55	AE222	Insert Sensor
DN494 - Polar Blast Chiller 40/28kg	56	AM123	Magnetic Stripe(A)(Left/Right)
DN494 - Polar Blast Chiller 40/28kg	57	AL865	Magnetic Stripe(B) (Up/Down)
DN494 - Polar Blast Chiller 40/28kg	58	AE242	Door Heating Element
DN494 - Polar Blast Chiller 40/28kg	59		Sealing Ring
DN494 - Polar Blast Chiller 40/28kg	60	AL264	Drain Pipe Cover
DN494 - Polar Blast Chiller 40/28kg	61	AK633	Filter Screen
DN494 - Polar Blast Chiller 40/28kg	62	AL405	Capacitor for Fan
DN494 - Polar Blast Chiller 40/28kg	63	AN960	Unit Board
DN494 - Polar Blast Chiller 40/28kg	64	AN772	Door Switch Box
DN494 - Polar Blast Chiller 40/28kg	N/A	AM936	Water Adapter Tube
DN494 - Polar Blast Chiller 40/28kg	N/A	AA637	Drain Pipe
DN494 - Polar Blast Chiller 40/28kg	N/A	AN278	Electrics for Compressor NT2210U
DN494 - Polar Blast Chiller 40/28kg	N/A	AE220	Down Hinge Left-Optional
DN494 - Polar Blast Chiller 40/28kg	N/A	AK134	Upper Hinge Left-Optional



Machine	Explode	Code	Description
DN494 - Polar Blast Chiller 40/28kg	1	AM146	Top
DN494 - Polar Blast Chiller 40/28kg	2	AN754	Hinge Fixed Board
DN494 - Polar Blast Chiller 40/28kg	3	AB888	Door Switch
DN494 - Polar Blast Chiller 40/28kg	4		Body Back Cover
DN494 - Polar Blast Chiller 40/28kg	5		Body
DN494 - Polar Blast Chiller 40/28kg	6	AK133	Door Hinge Axis
DN494 - Polar Blast Chiller 40/28kg	7	AG554	UK Plug
DN494 - Polar Blast Chiller 40/28kg	7		EU Plug
DN494 - Polar Blast Chiller 40/28kg	8		Unit Room Grill
DN494 - Polar Blast Chiller 40/28kg	9	AE238	Back Support Left & Right
DN494 - Polar Blast Chiller 40/28kg	11		Front Support Left & Right
DN494 - Polar Blast Chiller 40/28kg	10	AK185	Guide Left & Right
DN494 - Polar Blast Chiller 40/28kg	12	AK617	Door Switch Cushion
DN494 - Polar Blast Chiller 40/28kg	13	AF649	Door Seal
DN494 - Polar Blast Chiller 40/28kg	14	AL373	Door (Door With Handle)
DN494 - Polar Blast Chiller 40/28kg	15	AB287	Down Hinge Axis Jacket
DN494 - Polar Blast Chiller 40/28kg	16	AB346	Door Spring Hinge
DN494 - Polar Blast Chiller 40/28kg	17	AE220	Door Hinge
DN494 - Polar Blast Chiller 40/28kg	18		Support Tray Nut
DN494 - Polar Blast Chiller 40/28kg	19	AE824	Standard & Braked Castors
DN494 - Polar Blast Chiller 40/28kg	20		Unit Support Board
DN494 - Polar Blast Chiller 40/28kg	21		Water Box Guide
DN494 - Polar Blast Chiller 40/28kg	22	AB982	Water Box
DN494 - Polar Blast Chiller 40/28kg	23		Guide of Unit Board Left & Right
DN494 - Polar Blast Chiller 40/28kg	24	AH325	Solenoid Valve
DN494 - Polar Blast Chiller 40/28kg	25		Solenoid Valve Fixed Clip
DN494 - Polar Blast Chiller 40/28kg	26	AE225	Filter Drier
DN494 - Polar Blast Chiller 40/28kg	27	AE239	Thermostatic Expansion Valve
DN494 - Polar Blast Chiller 40/28kg	28	AK618	Protector For Water Pan
DN494 - Polar Blast Chiller 40/28kg	29	AF875	Water Pan
DN494 - Polar Blast Chiller 40/28kg	30		Receiver And Accumulator
DN494 - Polar Blast Chiller 40/28kg	31		Discharge Pipe (R404a)
DN494 - Polar Blast Chiller 40/28kg	32	AL479	Condenser (R404a)
DN494 - Polar Blast Chiller 40/28kg	33	AE228	Condenser Fan & Blade
DN494 - Polar Blast Chiller 40/28kg	34	AA658	Basket Guard Grill
DN494 - Polar Blast Chiller 40/28kg	35	AE240	Compressor (R404a)
DN494 - Polar Blast Chiller 40/28kg	36		Pipe Fixed Clip
DN494 - Polar Blast Chiller 40/28kg	37	AF808	Ac Contactor
DN494 - Polar Blast Chiller 40/28kg	38	AE241	Front Panel (old version)
DN494 - Polar Blast Chiller 40/28kg	38	AG970	Front Panel (incl. facia - new version)
DN494 - Polar Blast Chiller 40/28kg	39	AE226	Thermostat (old version)
DN494 - Polar Blast Chiller 40/28kg	39	AG968	Thermostat (From 5016829-UK, 13828-EU)
DN494 - Polar Blast Chiller 40/28kg	40	AP235	Thermostat Protector

DN494 - Polar Blast Chiller 40/28kg	41	AP236	Thermostat Cover
DN494 - Polar Blast Chiller 40/28kg	42		Condenser Fan Support
DN494 - Polar Blast Chiller 40/28kg	43	AA639	Sensor Fixed Clip
DN494 - Polar Blast Chiller 40/28kg	44	AB953	Probe Padding
DN494 - Polar Blast Chiller 40/28kg	45	AJ547	Room Temperature Sensor
DN494 - Polar Blast Chiller 40/28kg	46	AE236	Circuit Fan
DN494 - Polar Blast Chiller 40/28kg	47		Airflow Conduct Board
DN494 - Polar Blast Chiller 40/28kg	48	AK625	Inside Bottom Pan
DN494 - Polar Blast Chiller 40/28kg	49		Heat Preservation Foam
DN494 - Polar Blast Chiller 40/28kg	50		Circuit Fan Support
DN494 - Polar Blast Chiller 40/28kg	51	AK631	Heater
DN494 - Polar Blast Chiller 40/28kg	52	AK632	Drain Heater
DN494 - Polar Blast Chiller 40/28kg	53	AG965	Evaporator
DN494 - Polar Blast Chiller 40/28kg	54	AK135	Defrosting Sensor
DN494 - Polar Blast Chiller 40/28kg	55	AE222	Insert Sensor
DN494 - Polar Blast Chiller 40/28kg	56	AM123	Magnetic Stripe(A) (Left/Right)
DN494 - Polar Blast Chiller 40/28kg	57	AL865	Magnetic Stripe(B) (Up/Down)
DN494 - Polar Blast Chiller 40/28kg	58	AE242	Heating Element
DN494 - Polar Blast Chiller 40/28kg	59		Sealing Ring
DN494 - Polar Blast Chiller 40/28kg	60	AL264	Drain Pipe Cover
DN494 - Polar Blast Chiller 40/28kg	61	AK186	Evaporator Water Pan
DN494 - Polar Blast Chiller 40/28kg	62	AK633	Filter Screen
DN494 - Polar Blast Chiller 40/28kg	63	AG970	Thermostat Sticker
DN494 - Polar Blast Chiller 40/28kg	64	AL405	Capacitor for Fan
DN494 - Polar Blast Chiller 40/28kg	65	AN960	Unit Board
DN494 - Polar Blast Chiller 40/28kg	N/A	AG157	Door Nut
DN494 - Polar Blast Chiller 40/28kg	N/A	AK419	Drain Pipe
DN494 - Polar Blast Chiller 40/28kg	N/A	AA634	Drain Pipe Nut
DN494 - Polar Blast Chiller 40/28kg	N/A		Electrics for Compressor NJ2212GK